



Residence Life Guide To Living On Campus First Year Student Edition



20
26

COURAGE TO BE MORE



MISSION

The Saint Leo University Office of Residence Life empowers students to develop a safe and inclusive living experience that promotes a thriving community of holistic student learning.





COMMUNITY AMENITIES

WiFi, Free Laundry, Game Room, Study Lounges, Ping Pong Tables, Basketball Court, In-Hall Fitness Areas, Sand Volleyball Courts and Charcoal Grill/ Picnic Areas. The Esports Arena will have posted hours for open play time when the team is not practicing or competing.



FLOOR PLAN FIRST YEAR AREAS

14'L X 11'W



Snyder Double

18'L X 10'W



Benoit/Henderson Double

10'L X 10'W



Roderick Single

16'L X 10.5'W



Alumni Double Room / Snyder Garden Level

Housing Placement for Transfer Students

If you are transferring to Saint Leo University with fewer than 19 completed college credits, you will be placed in first-year student housing.

This ensures you have access to the same resources, support systems, and community connections that help new students transition successfully into life at Saint Leo.

For the latest pricing information, please visit: <https://www.saintleo.edu/board-rates>



WHAT SHOULD I BRING?

SOME COMMON THINGS INCLUDE:

- Bathrobe/Towels
- Bedding for a standard twin bed
- Can opener
- Cleaning supplies
- Clothes hangers
- Desk lamp
- Flashlight with batteries
- Laundry basket and detergent
- Microwave
- Mini Fridge
- Plastic containers for dry food
- Pictures/posters
- Shower caddy
- Trash can
- Vacuum cleaner/ broom
- 6 Outlet UL Rated Surge Protector



Roderick



Snyder



Henderson & Benoit



Alumni

WHAT COMES WITH THE ROOM?

Each room is furnished with a desk chair, standard twin bed, dresser, and wardrobe/closet.

CAN I BRING A CAR?

[View our current parking permit rates here.](#) Students are strongly encouraged to register their vehicle online to help avoid long lines at the beginning of the semester. To register a vehicle online simply click the button below. You will need your Saint Leo Portal ID and password to access this form. This form is only compatible with Internet Explorer web browser. Once completed, a decal will be assigned and billed to your student account. It will then be available for pick-up upon arrival on campus for the semester.

CAN I BRING A BIKE?

Bicycles may be kept in rooms as long as both roommates agree. Bike racks are also located outside residence halls. All students bringing bicycles to campus must register them with University Safety to receive their free bicycle decal.

BATHROOM STYLES

Our residences feature two bathroom styles: community style and suite-style.

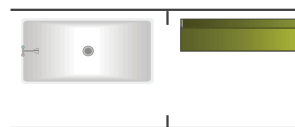

Community style bathrooms feature showers in one centralized location where there are multiple stalls with a changing station.

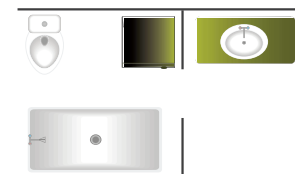

Suite-style bathrooms include a shower, sink and toilet that is shared by individuals living in the same suite.

FLOOR PLAN & PRICING LOWER CLASS AREAS

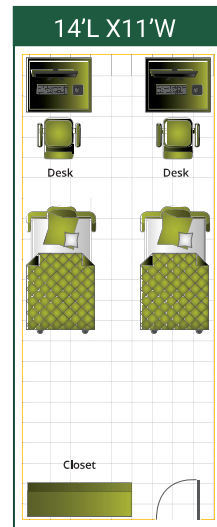

Snyder Double



Roderick Single

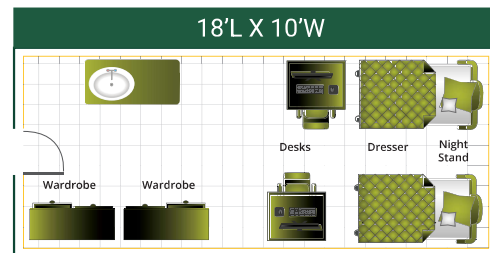

Benoit/Henderson Double

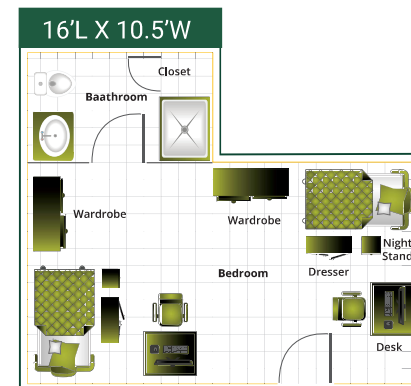

Alumni Double Room / Snyder Garden Level

For the latest pricing information, please visit: <https://www.saintleo.edu/board-rates>

All full-time University Campus students are required to live on campus (exceptions are allowed for those students living and commuting from home, married students, veterans, non-traditional students, or senior students who have earned over 90 credit hours). Qualify for exemption with financial implications. If you opt out after signing a contract, it's more complicated with financial ramifications.

Students must be **17** years or older to live on campus. Approval is needed from the Director of Residence Life for exceptions to this policy.



MEAL PLAN INFORMATION



19 Meal Plan.....
10 Meal Plan.....
5 Meal Plan.....
Commuter Meal Plan (block of 25 meals).....

For the latest pricing information, please visit:
<https://www.saintleo.edu/board-rates>

- Students in Alumni, Roderick, Benoit, Henderson, Snyder, Apartments 1-6 with kitchenette are required to have the 19 meal plan.
- Students in Apartments 1-4 with a kitchen are required to choose a 5, 10, or 19 meal plan.
- Meal plan is chosen during the Housing Selection Process.
- All students will be assigned the 19 meal plan unless another meal plan is chosen during the Housing Selection Process.





RESIDENCE LIFE STAFF

LOVE TO LIVE HERE

THE DEPARTMENT OF RESIDENCE LIFE STAFF WORKS TO PROVIDE SUPPORT, GUIDANCE, AND ASSISTANCE TO 1,547 RESIDENTIAL STUDENTS

Our professional staff team is comprised of the Director of Residence Life, Assistant Director of Residence Life, Manager of Housing Operations, and a Residence Coordinator.

In addition to the professional staff, we have 6 graduate assistant (GA's), and 46 Resident assistants (RA's).

Both students and professional staff are available 24 hours a day, 7 days a week for assistance.

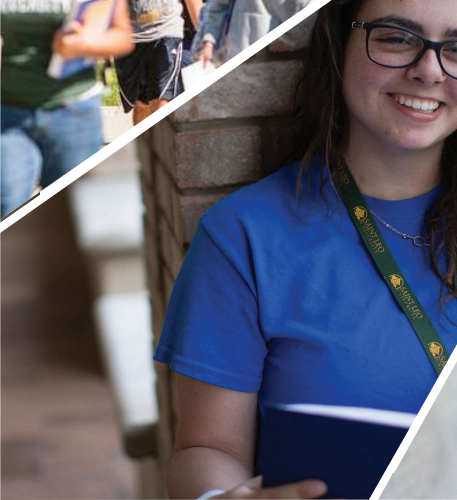
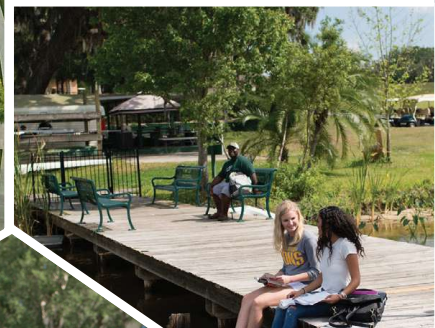
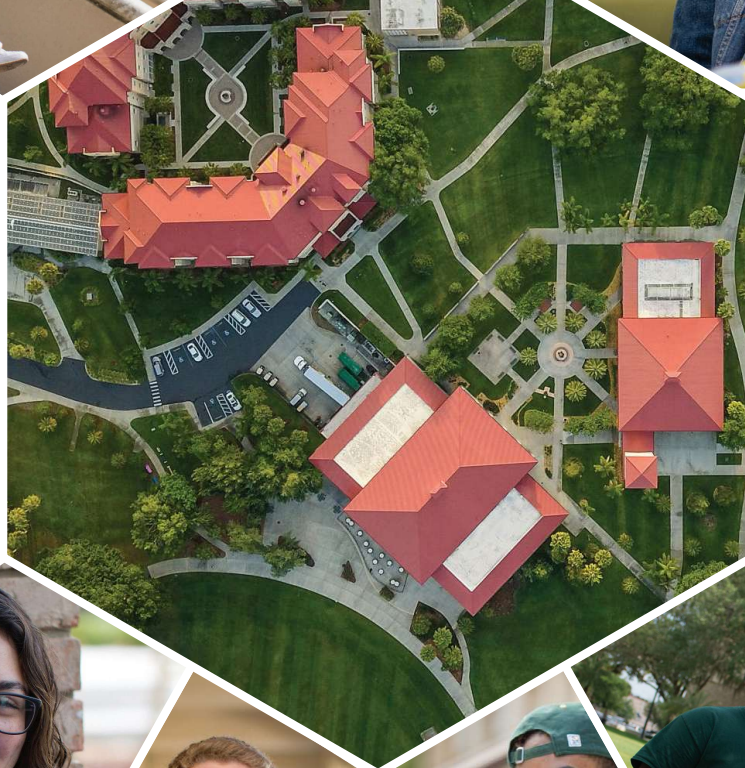
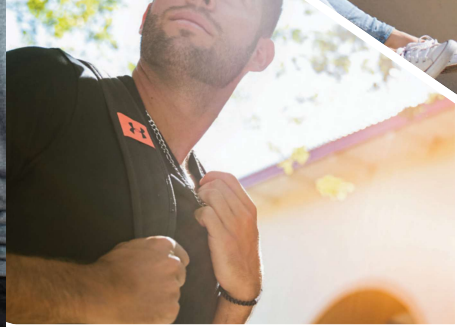

LIVING LEARNING COMMUNITES (LLC)



What are the benefits of being a living-learning community resident?

- Live and learn alongside students with similar interests.
- Experience exciting programs that relate to your interests.
- Give back to the local and global community through service.
- Have a better connection with Saint Leo University faculty and staff members.
- Research shows that students who take part in theme floor communities have higher GPAs, enjoy a better college experience, and gain more leadership skills than their peers who are not in a Living Learning Community.

Members of these communities will have the opportunity to:

- Become involved in developing community standards and planning the future of the Living Learning Community Explore and participate in opportunities provided by The Office of Residence Life, and Academic Affairs Each
- semester, members of these communities will be expected to:
- Participate in the Opening Kick-Off Dinner

Be an active member of the Living Learning Community by:

- Participating regularly in community programs and activities
- Register for any required classes and attend (Prayer and Mindfulness only)
- Help build community on the floor through positive shared experiences
- Provide feedback and take part in developing the LLC for future community members
- Maintain a 2.5 cumulative/semester GPA and be in good conduct standing

This year, the Office of Residence Life offers four Living Learning Communities that residential students can choose from.

HONORS LIVING LEARNING COMMUNITY

Located in Roderick Hall 1st floor: This community fosters an environment where students can focus on academic achievements and successfully transition to Saint Leo University. This community is open to first-year students who are in the Saint Leo University Honors Program. The Honors LLC will incorporate faculty and staff activities to help residents succeed academically during their first year.

NURSING LIVING LEARNING COMMUNITY (LLC)

Located in Alumni Hall 2nd floor: The Nursing Living Learning Community (LLC) fosters an environment where students can focus on first year nursing requirements and successfully transition to Saint Leo University. This community is open to first-year students who are Bachelor of Science in Nursing (BSN) students. The nursing community will incorporate faculty and staff activities to help residents succeed academically during their first year. This LLC is located in Alumni Hall. Applications for Nursing LLC Housing will open mid-May of each academic year. Students who qualify for this LLC will receive an email indicating when the applications are open. Nursing LLC Housing will likely fill before the final deadline for housing applications, which is Friday, June 5, 2026. All applications must be submitted to the Office of Residence Life through the Residence system.

PRAYER AND MINDFULNESS LIVING LEARNING COMMUNITY (LLC)

Located in Building 2 1st floor: The core of this LLC experience is a unique integration of learning and living. Participants take a one-credit-hour class, "Prayer and Mindfulness," in the fall semester, which introduces universal principles of prayer and mindfulness. Through readings and assignments, students explore various prayer practices, selecting one to focus on as part of their personal growth. These practices are rooted in the Benedictine tradition and are common to many religions, making the class accessible and meaningful for students of all backgrounds.

ESPORTS AND GAMING LIVING LEARNING COMMUNITY (LLC)

Located in Building 5 1st floor: The Esports and Gaming Living Learning Community (LLC) is perfect for students who have a passion for esports or gaming. By choosing this LLC, students will have the opportunity to live and learn alongside like-minded peers, engaging in specialized events, programs, and activities designed to foster connections with fellow students, faculty, and staff. The community will also feature a faculty-led program, and students will have the unique chance to game alongside faculty and staff, building meaningful relationships outside the classroom. Participants will also have exclusive access to a dedicated space equipped with games, gaming PCs, consoles, and other gaming equipment.

All incoming students will receive an email to join a LLC.

Please note that you will be placed in its perspective housing areas if you are selected to be an LLC member.

WHAT OUR RAs DO



Resident Assistants serve an important role in assisting with the safety and security of students and serve in a rotation ensure students have 24:7 access to staff. Roles of a Resident Assistant include:

- Host monthly programs to build community with residents on the floor and in the building
- Trained in mediation to assist with roommate conflicts
- Familiar with campus resources and can connect students to appropriate campus offices
- Serve as a mentor and support system to residents
- Provides support to residents who may need assistance (lock-outs, maintenance concerns, etc.)

STUDENT CODE OF CONDUCT

The Code of Conduct sets the University's expectations for student behavior. All students are expected to review the Code of Conduct to gain an understanding of our policies. Students are encouraged to review additional residence hall specific information in the Guides to Residential Living. Following the Code of Conduct helps create a safe environment for our Saint Leo students.



APPLY FOR HOUSING NOW NEW INCOMING STUDENTS

1. Work with your Admissions Counselor on all admission requirements including deposit.
2. Newly admitted students will be able to access the residence system/housing portal 72 hours after their deposit.
3. Before you can access your housing application online you will need to set up your Saint Leo Email account and password.
4. To access your housing application, log onto your online residence system (housing portal) account at slu-residence.symlicity.com/index.php/pid911004 and follow the instructions for logging in.
5. After you log into your account, click the blue „Get Started” button on your home screen and begin your housing application
6. Once you have completed your housing application be sure you have clicked the "Submit" button!
7. You should receive a confirmation that your housing, approved within 48 business hours.

Saint Leo University Residence Life

website <https://www.saintleo.edu/residencelife>







CONTACT INFORMATION

Suite 1002, Apartment 6
 University Campus-MC 2068
 Post Office Box 6665
 Saint Leo, Florida 33574

Phone: 352-588-8268
residence.life@saintleo.edu



- 1. University Safety & Emergency Management
- 2. Music Building
- 3. Department of Information Technology
- 4. Chiller Plant
- 5. U.S. Post Office
- 6. Saint Leo Abbey Gift Shop
- 7. Abbey Church
- 8. Benedictine Monks of Saint Leo Abbey
- 9. Daniel A. Cannon Memorial Library
 - Commuter Student Commons
 - Graduate Student Den
- 10. Saint Francis Hall
- 11. Saint Edward Hall
 - Financial Aid
 - Registrar
- 12. Tapia College of Business
- 13. Lewis Hall
- 14. Selby Auditorium
- 15. Kirk Hall
 - Student Success
- 16. DeChantal Hall
 - Athletic Offices
- 17. Marion Bowman Pool
- 18. Marion Bowman Activities Center
 - Athletics
- 19. Marion Bowman Gymnasium
- 20. Turf Stadium (Lacrosse) / Parking Garage
- 21. Alumni Residence Hall
- 22. Roderick Residence Hall
- 23. Benoit Residence Hall
- 24. Benedict's Coffeehouse
- 25. Henderson Residence Hall
- 26. Thomas B. Southard Baseball Stadium
 - Pete Biscardi Field
- 27. Tennis Courts
- 28. Intramural Field
 - Shot Put Field
 - Hammer Throw and Discus Field
- 29. Beach Volleyball
- 30. Mary Cannon Cabot Stadium
- 31. Soccer Field
 - Track and Field
- 32. Fine Arts Building
- 33. Student Apartments 5-6
 - Residence Life
- 34. Ropes Course
- 35. Student Apartments 1-4
- 36. Lakefront Access
- 37. Lake Jovita
- 38. Military Resource Center (MRC)
- 39. Saint Leo Abbey Cemetery
- 40. The Bowl
 - Accessibility Services
 - Center for Global Engagement
- 41. Student Community Center
 - Stephen Herrmann Mail Center
 - Bookstore
 - Dining Hall
 - Greenfelder-Denlinger Boardrooms
 - FUZ, Saint Leo University Fusion Eatery
- 42. Saint Jude Chapel
- 43. Student Activities Building (2nd Floor)
 - University Admissions
 - Marmion-Snyder Residence Halls
 - Wellness Center
 - Benedictine Hall
 - Alumni Center
 - Black Box Theatre
 - Department of Nursing
 - The Villa
 - Benfica Residential Academy Offices
 - Benfica Residential Academy Soccer Field Parking
- 44. University Admissions
- 45. Marmion-Snyder Residence Halls
- 46. Wellness Center
- 47. Benedictine Hall
 - Alumni Center
 - Black Box Theatre
 - Department of Nursing
- 48. Facilities Management
- 49. Crime Scene House
- 50. The Villa
 - Benfica Residential Academy Offices
 - Benfica Residential Academy Soccer Field Parking
- P Parking





Follow us Today

 @SaintLeoResLife

 @SaintLeo.ResLife